

Schematic:

REV.	ECN NO.	DESCRIPTION	DATE	APPD
A6	REL		2011/06/13	

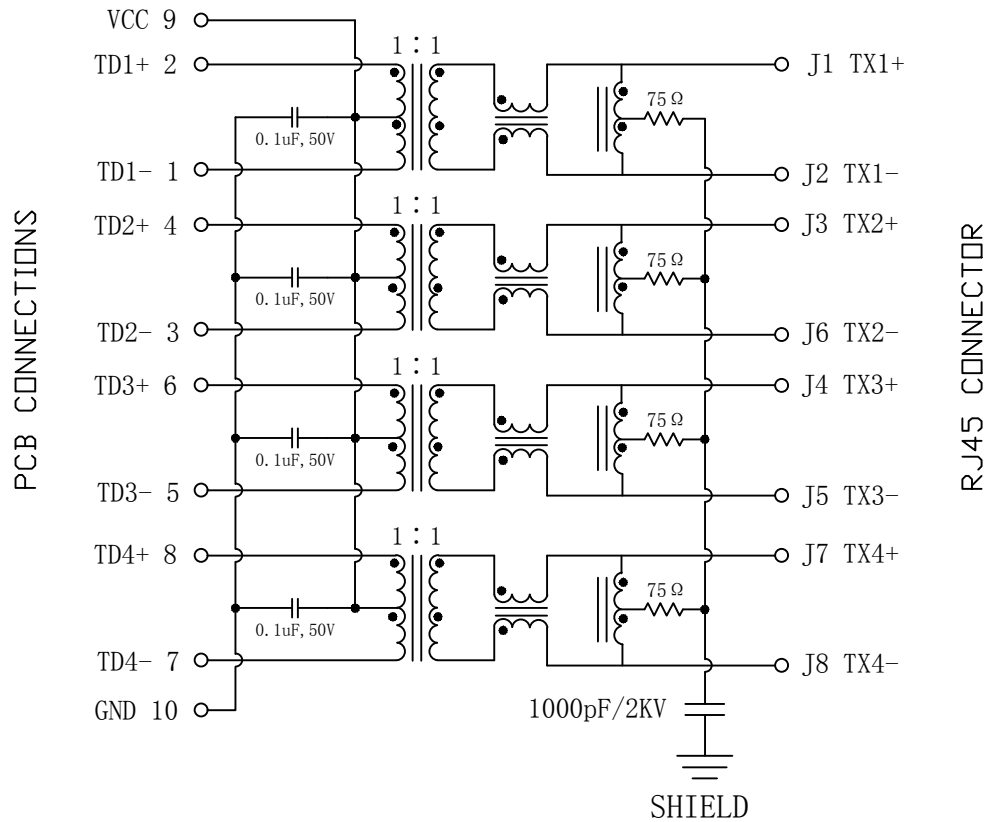

Electrical Specifications @25°C

1. OCL (100KHz, 0.1V, 8mA DC BIAS):
350uH MIN
2. Insertion Loss:
0.5~100MHz: -1.1dB MAX
3. Return Loss:
0.5~40MHz: -18dB MIN
40.1-100MHz: $-[12-20\text{LOG}(f/80)]$ dB MIN.
4. Crosstalk:
0.5~40MHz: -35dB MIN
40.1-100MHz: $-[33-20\text{LOG}(f/50)]$ dB MIN.
5. Common Mode Rejection Ratio:
0.5~100MHz: -30dB MIN
6. Isolation PHY SIDE To Line SIDE : 1500Vrms
7. Operating Temperature: 0°C TO +70°C.

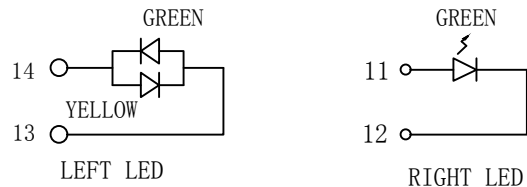

Emitting Color	λ_p (nm)	V _F @I _F =20mA	I _R @V _R =5V
GREEN	565	1.8~2.6V	10 μ A max
YELLOW	585	1.8~2.6V	10 μ A max

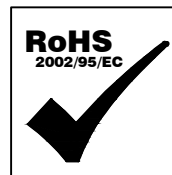

X:X	± 0.20	APPD: TOM	LINK-PP INT'L TECHNOLOGY CO., LIMITED
X:XX	± 0.10	CHKD: JAMES	
X:XXX	± 0.05	DR: LEO	TITLE: RJ45 Connector With 1000 Base-T Integrated Magnetic TAB UP
ANGLES	$\pm 1^\circ$	UNIT: mm	PART NO.: LPJG28831A52NL
	SCALE: 2/1	SHEET: 1/2	REV: A6 DWG: LP11061333

Mechanical :

REV.	ECN NO.	DESCRIPTION	DATE	APPD
A6	REL		2011/06/13	

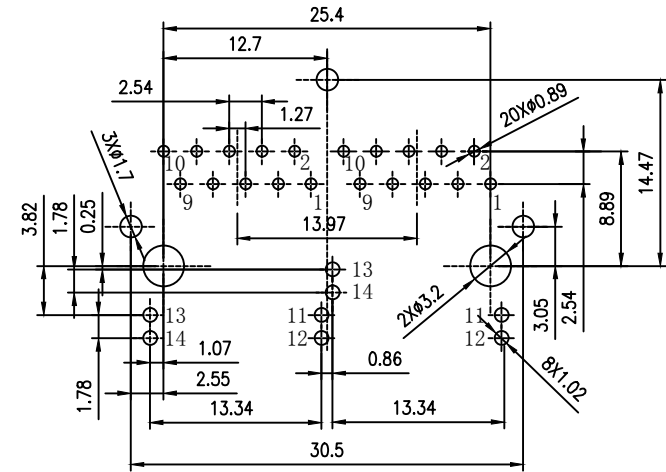
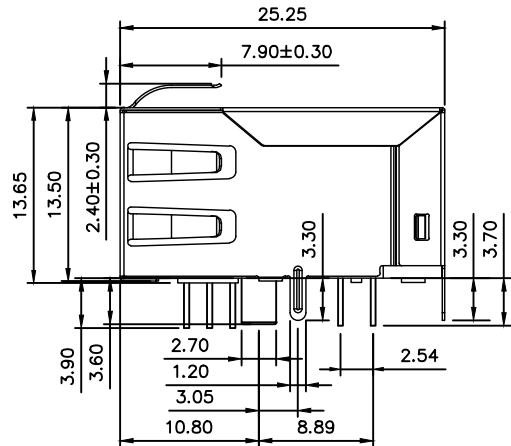
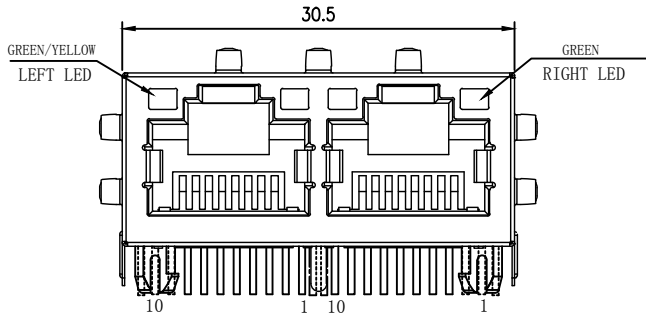

SUGGESTED PCB LAYOUT (TOP VIEW)

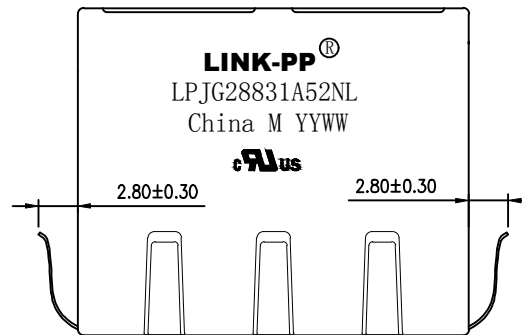
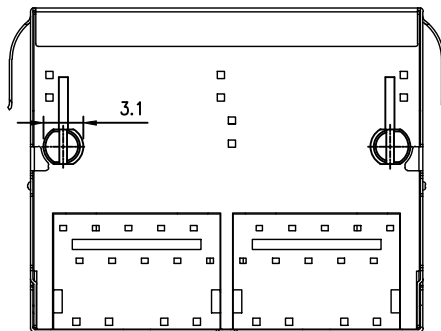

NOTES:

1. Designed to support application, such as SOHO (ADSL modems), LAN-on-Motherboard (LOM), hub and Switches.
2. Meets IEEE802.3 specification.
3. Connector Materials:
 Housing: Thermoplastic PBT+30%G.F UL94V-0
 Contact: Phosphor Bronze C5210R-EH Thickness=0.35mm
 Pins: Brass C2680R-H Thickness=0.35mm
 Shield: SUS 304-1/2H Thickness=0.2mm
 Contact plating: Gold 6 micro-inches min. In contact area.
4. Wave solder tip temperature: 250°C, 5 Sec.
5. UL Certification: File Number E484635.

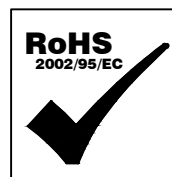

X:X	±0.20	APPD:	TOM	LINK-PP INT'L TECHNOLOGY CO., LIMITED
X:XX	±0.10	CHKD:	JAMES	
X:XXX	±0.05	DR:	LEO	TITLE: RJ45 Connector With 1000 Base-T Integrated Magnetic TAB UP
ANGLES	±1°	UNIT:	mm	PART NO.: LPJG28831A52NL
	SCALE:	2/1	SHEET:	2/2
	REV:	A6	DWG:	LP11061333